

5V CRIMP

26 gauge

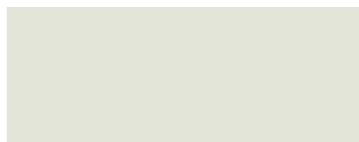

5V Crimp panels are a simple yet beautiful solution to your residential and light commercial roofing needs. 5V Crimp's high strength steel and light colors will maintain their good looks for years to come.

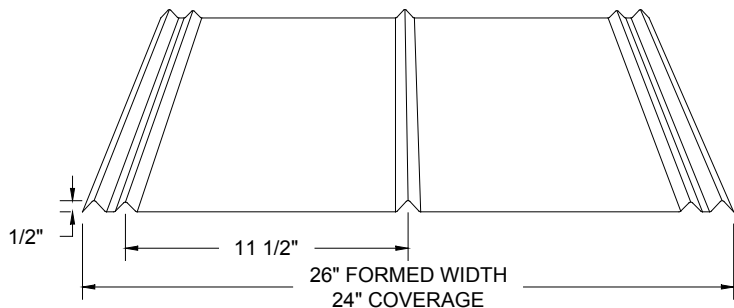

Brite White 824 IR = .60



Antique Bronze 854 IR = .20



Evergreen 875 IR = .25



Charcoal Gray 851 IR = .18



Brick Red 898 IR = .31 *



Acrylic Coated Galvalume IR = .68 *

Colors shown are as actual as allowed by the printing process. Actual metal samples are available.
IR=Initial Solar Reflectivity



* Energy Star approved.

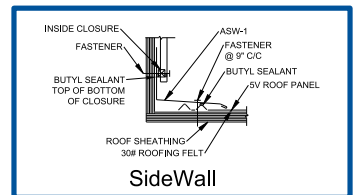
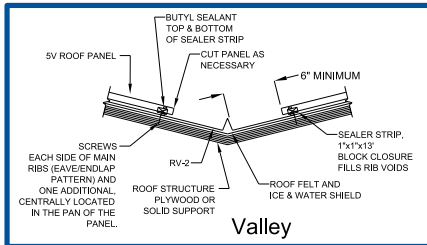
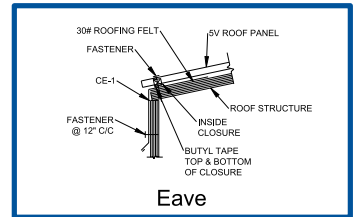
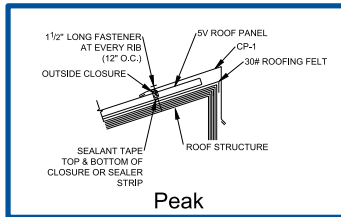
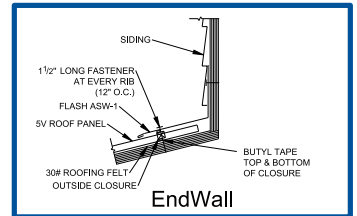
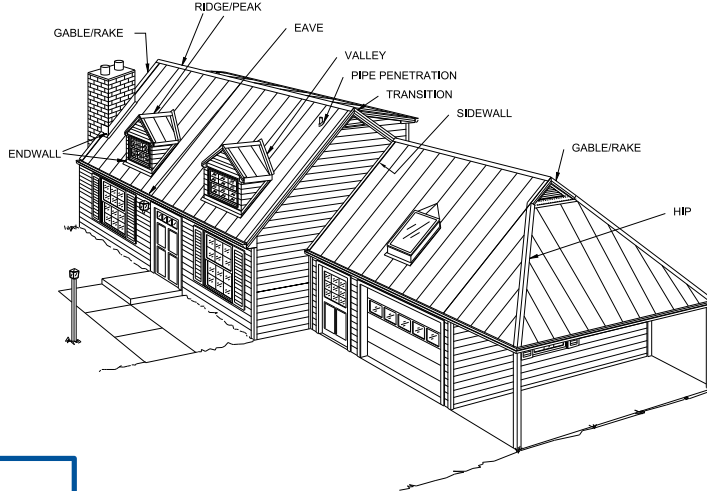
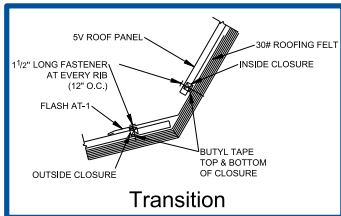
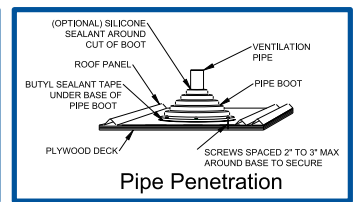
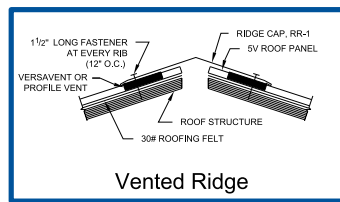
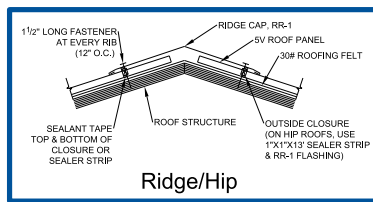
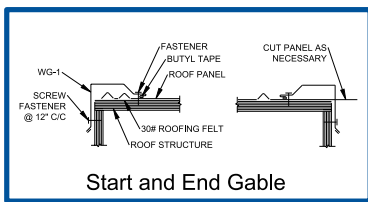

TYPICAL RESIDENTIAL DETAILS

26 GA 5V Crimp

Load-Span Tables for 26 GA 5V Crimp
Allowable wind uplift loads (psf)

Substrate	Fastener	9"	12"	15"	18"	21"	24"	27"	30"	36"
1/2" Plywood	#14 x 1" MP	123.8	92.8	74.3	61.9	53.0	46.4	40	32	22
7/16" OSB	#14 x 1" MP	74.6	56.0	44.8	37.33	32.0	28.0	24.8	22.4	18.6
Solid 2x SPF	#10 x 1" Woodgrip	323.1	202.0	129.0	90.0	66.0	51.0	40.0	32.0	22.0
	Screws per Square	142	108	88	76	64	58	54	48	44

The above loads and fastener quantities are based on the standard fastening schedule for 5V Crimp, with the fastener having an embedment depth of 1" when using solid wood. Contact FABRAL for additional design information on our products.

Specifications subject to change without notice or obligation to make changes in product previously purchased.



Enduracote™ is a paint system that takes performance to the next level. Based on cutting edge resin technology, this system offers unbeatable durability and superior long-term performance against the elements. Enduracote is the choice for low maintenance, lasting beauty and outstanding value.

5V Crimp Warranty

- Lifetime film integrity warranty for walls and roofs
- 30-year warranty against fade and chalk for walls and roofs
- 10-year edge rust warranty against acid rain

Manufacturing Locations:
55 Lamb Loop Road
Tifton, GA 31793
(800) 749-8144

Highway 70 North
Idabel, OK 74745
(800) 926-8509



a Euramax company

Facilities Nationwide
Corporate Office
3449 Hempland Rd.
Lancaster, PA 17601
(800) 477-2741
www.fabral.com

98-32-510
6/08 5k